

# heatwave extralarge

## Montážní návod - Montážne pokyny

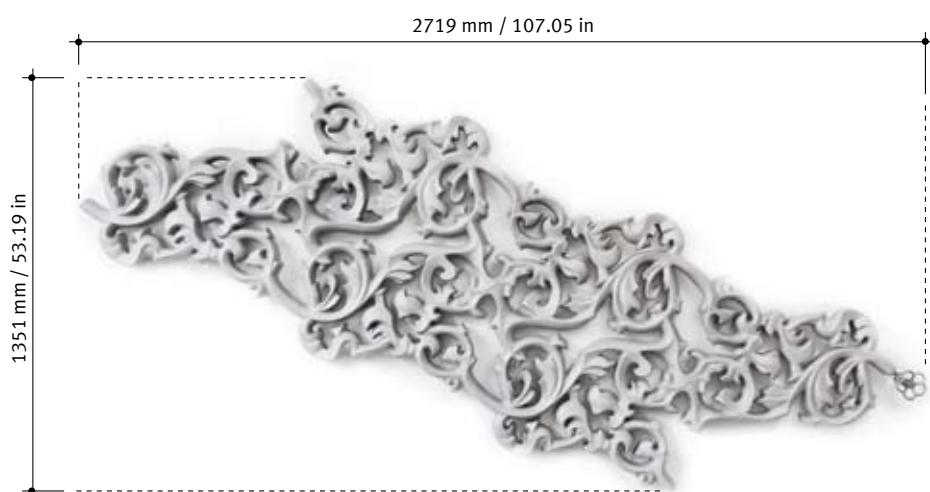

\*Standardní poloha  
\*Štandardná poloha



\* Těleso Heatwave může být namontováno v jakémkoliv úhlu 360 °.  
- Poloha tělesa zobrazená v manuálu je polohou orientační, doporučenou designérem.

\* Heatwave může být namontován v akomkoľvek uhly 360°.  
- Poloha telesa zobrazená v manualy je poloha orientačná, doporučená designérem.

84 kg / 186 lb

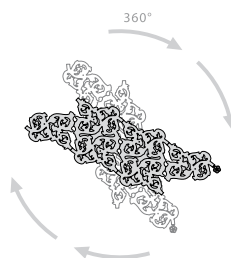
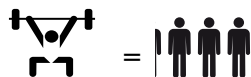

Jednotlivé díly - Súčiastky

A

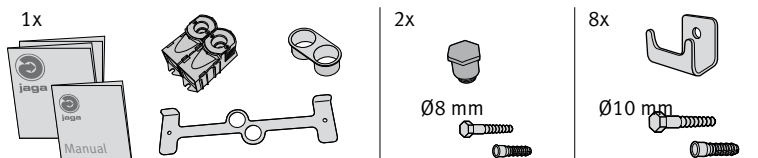

B

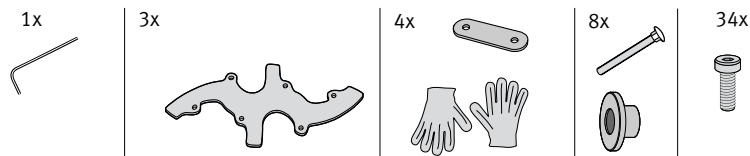

C

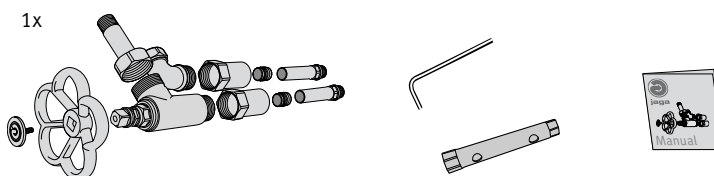

poznámka

Těleso Heatwave je ručně vyráběný výrobek, z toho důvodu mohou být někdy patrné drobné barevné a rozměrové odchylky. Po prvním ošetření budou mít barevné odchylky tendenci překrýt povrchový materiál.

Teleso Heatwave je vyrábáný ručně, z toho dovodu je možná nepatrná odchylka farby a rozmeru. Po prvom ošetrení majú drobné farebné odchylky tendenciu prekryť povrchový materiál.

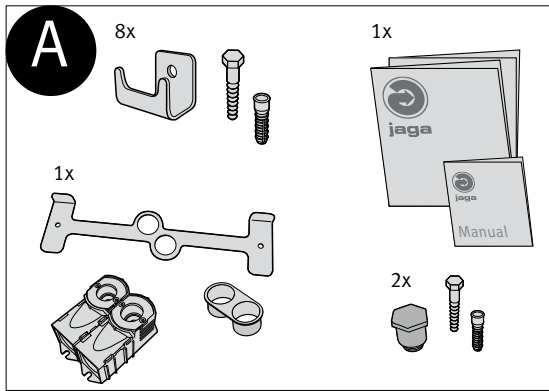

Vyjměte instalační šablonu, upevnění a připojení ventilů z balení.  
 Vyberte instalační šablonu, upevnenie a prípojenie ventilov z balenia.

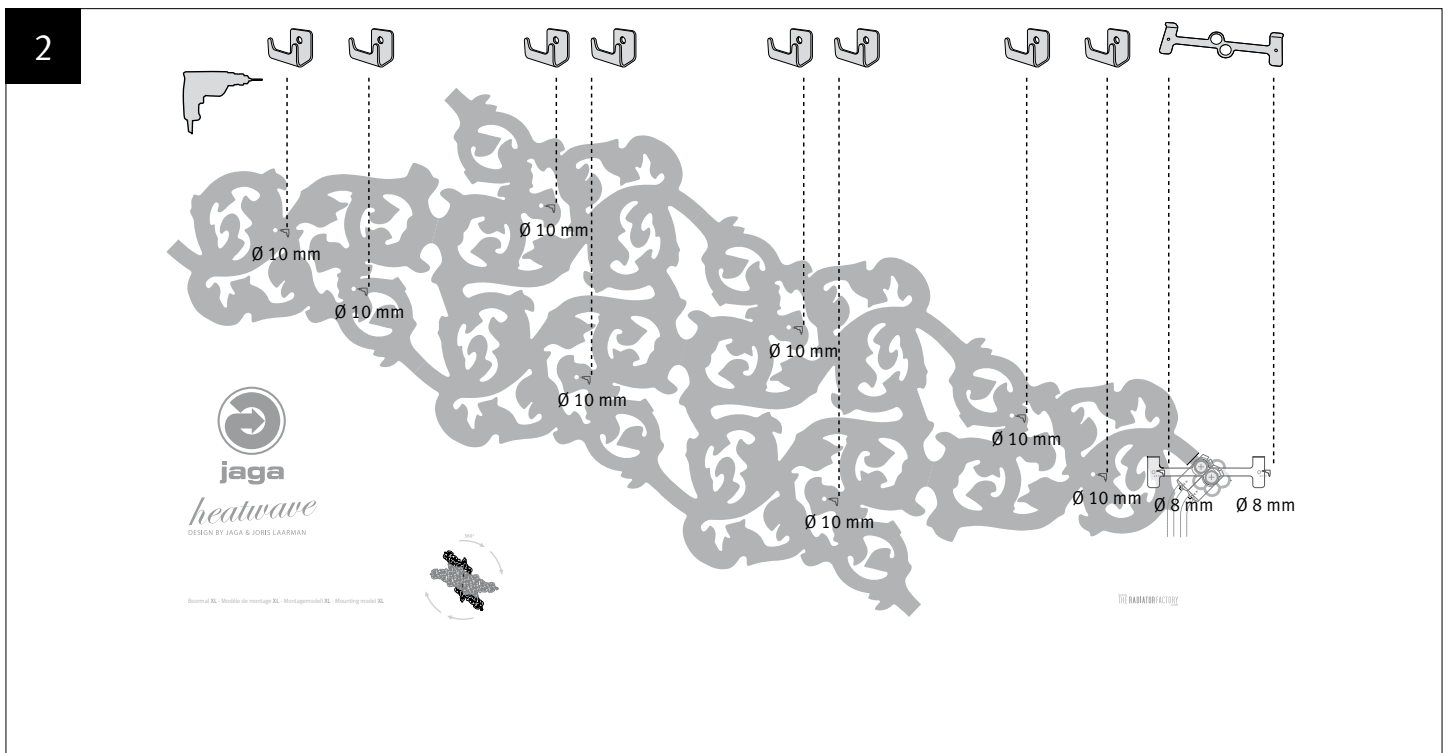

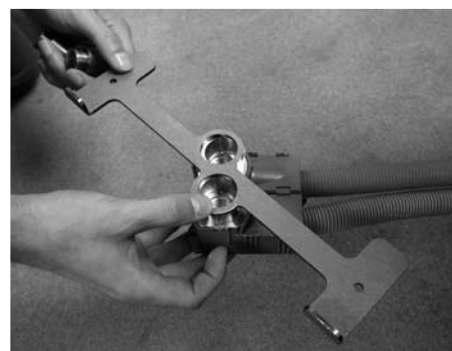
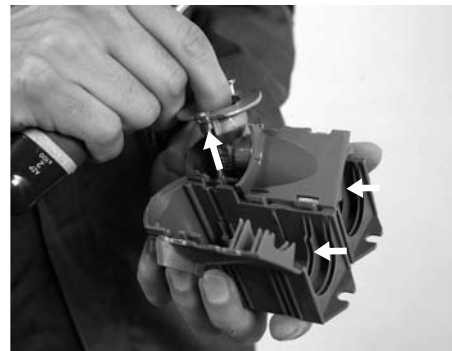
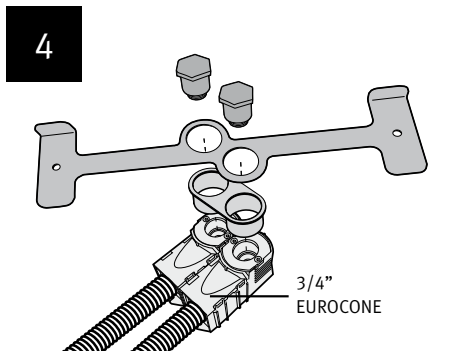
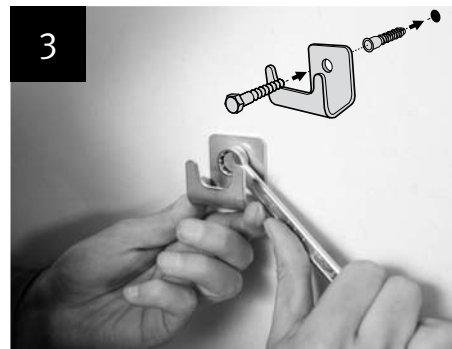
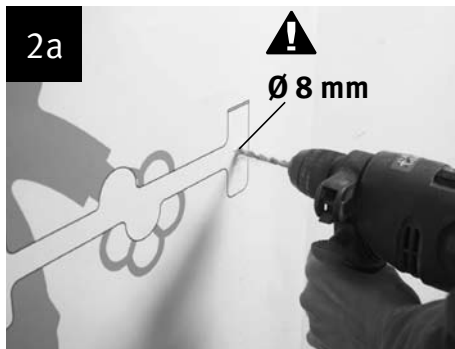



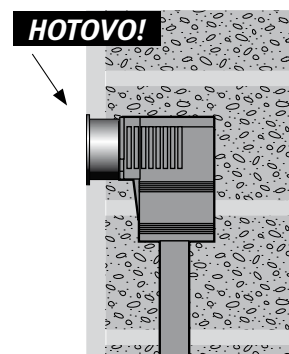
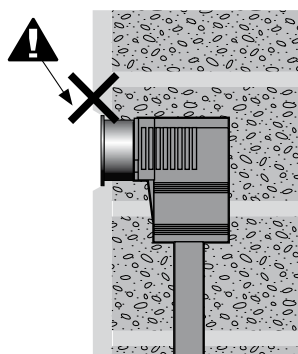
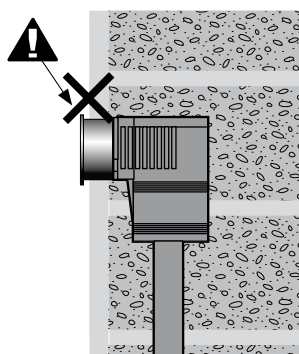
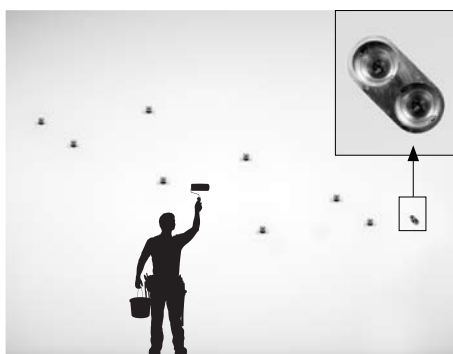
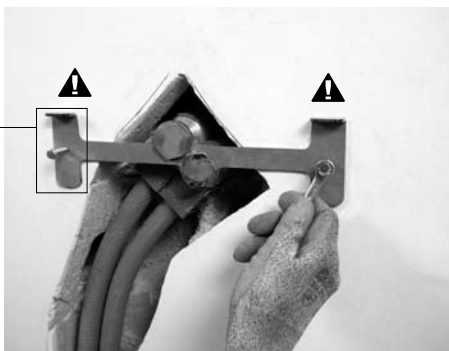
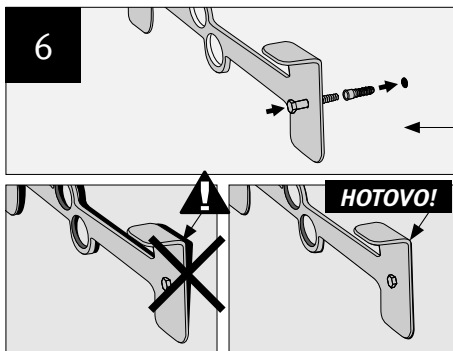
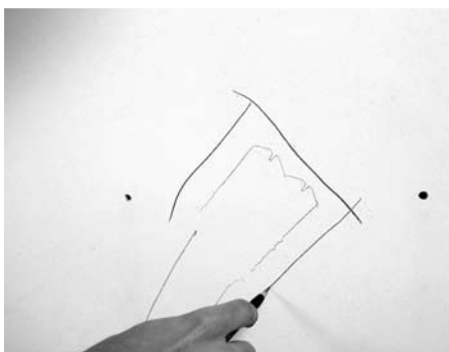
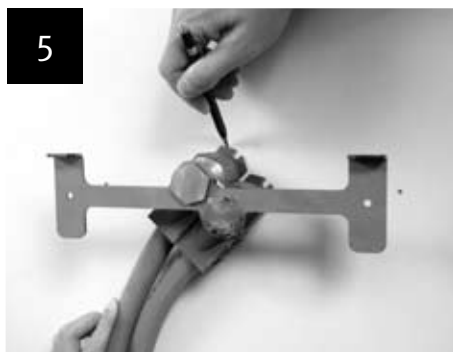

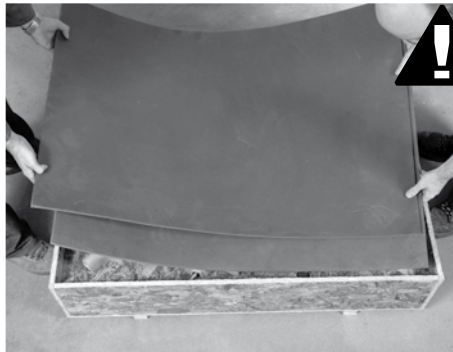
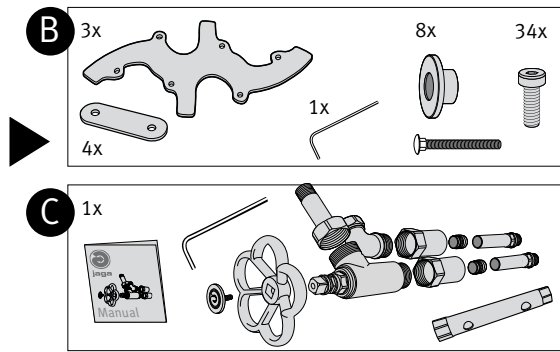
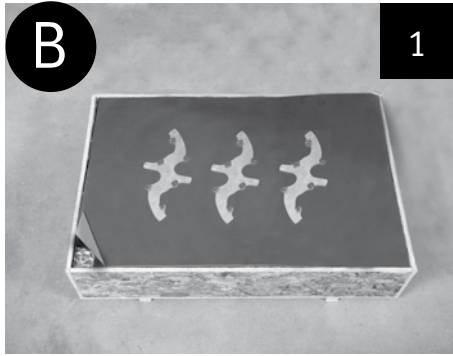

Molitanová podložka je dodávaná z dôvodu ochrany telesa během kompletace. Před instalací na zeď prosíme, aby jste těleso sestavili na této podložce na podlaze.

Molitanová podložka je dodávaná pre ochranu telesa počas kompletáže. Pri montáži telesa poprosíme, aby kompletáž telesa prebiehala na mol. podložke položenej na zemi.

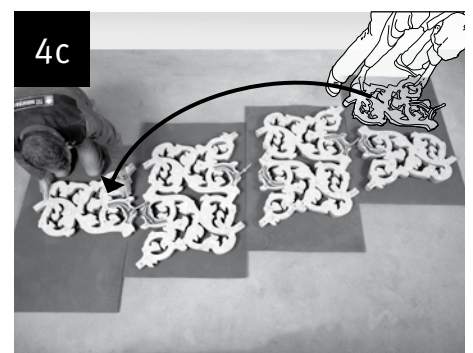
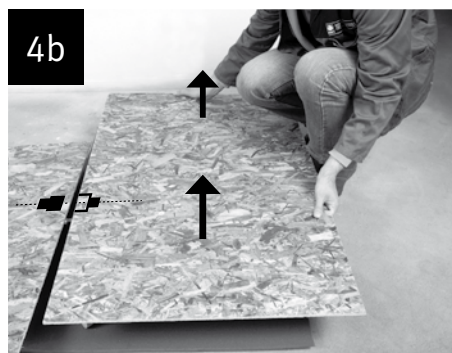
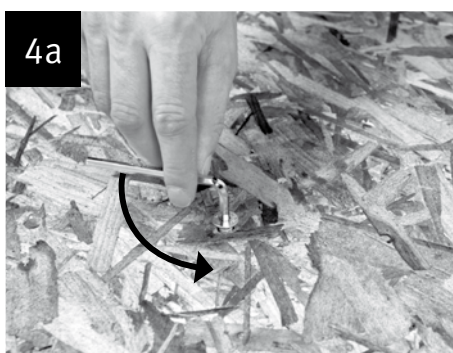
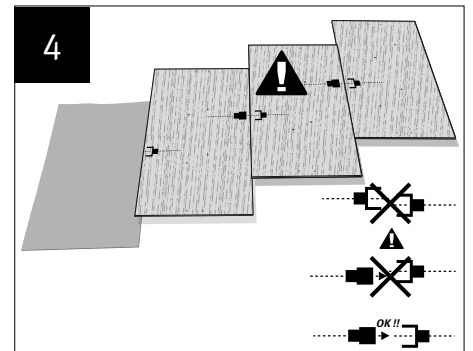
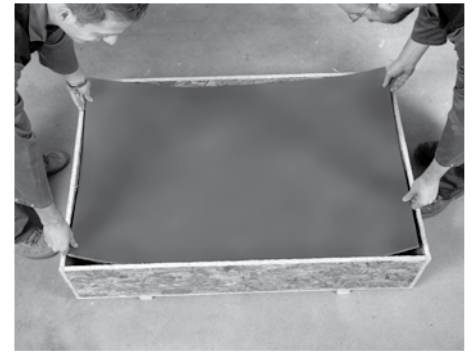
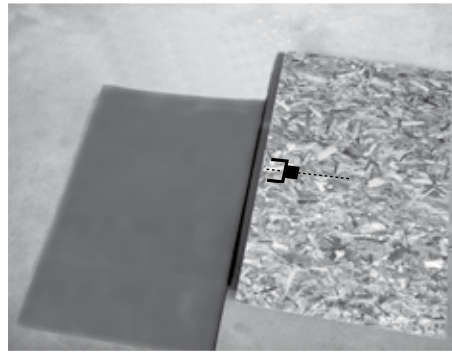
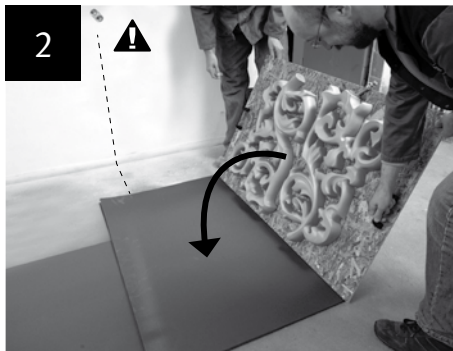



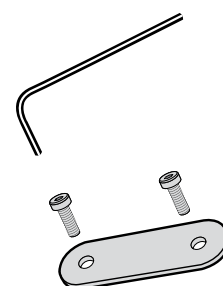
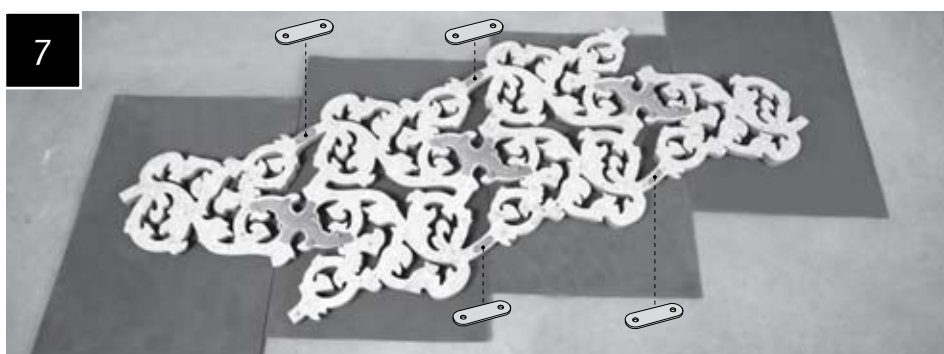
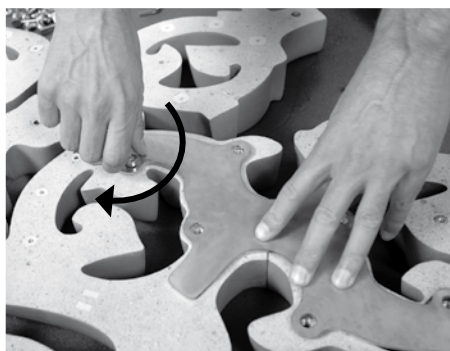
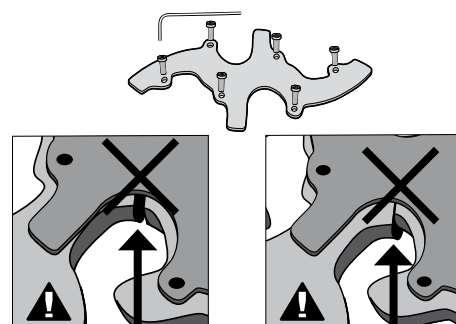
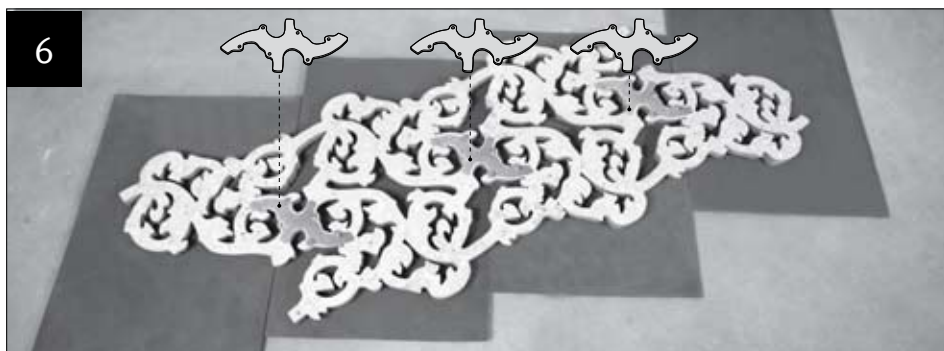
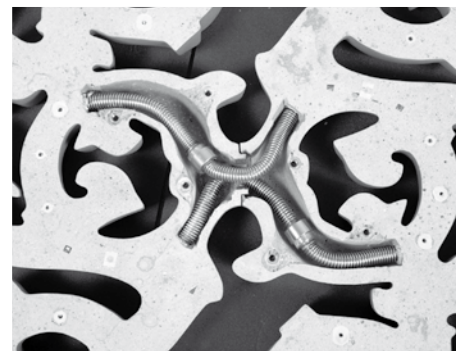
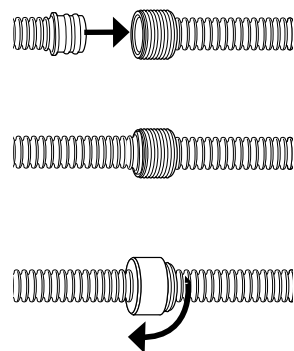
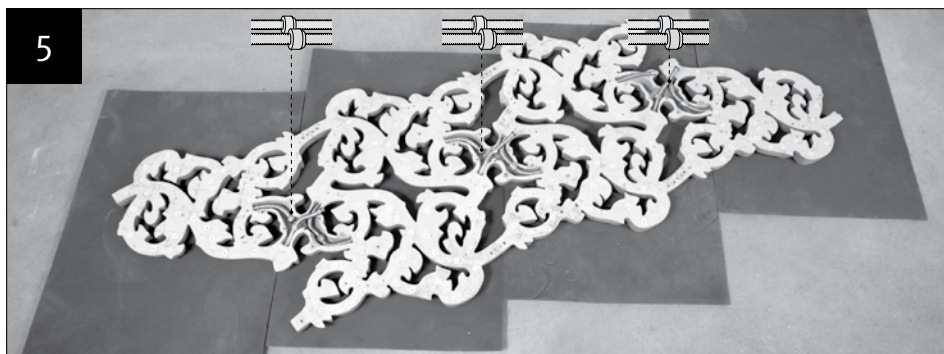

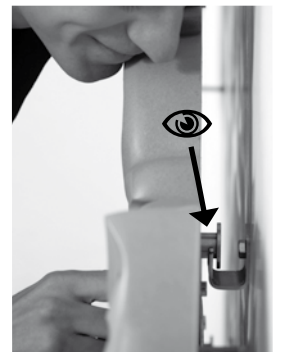
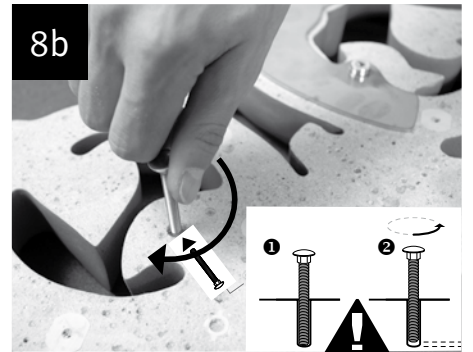
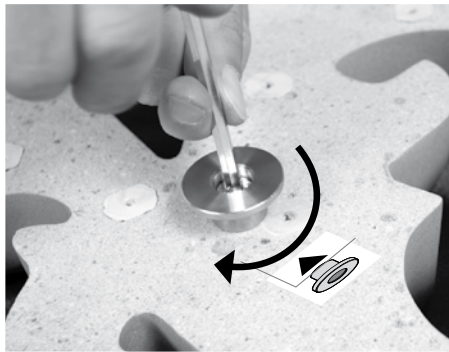
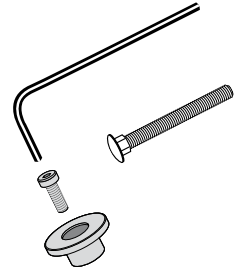
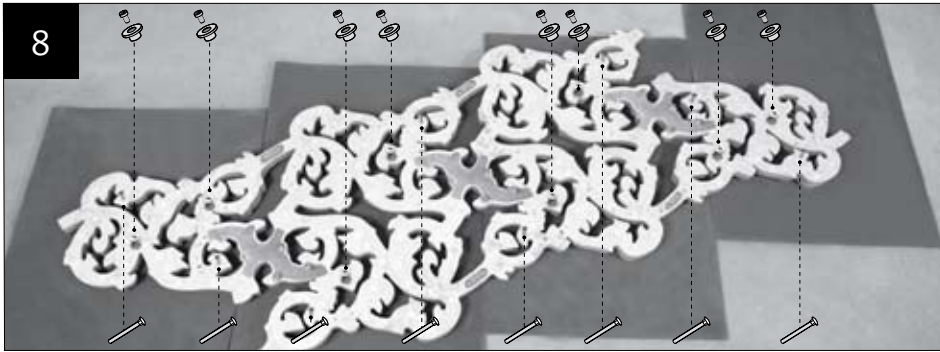
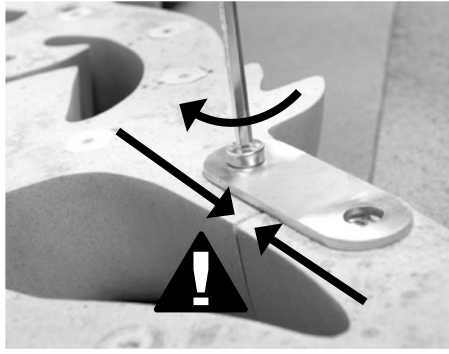
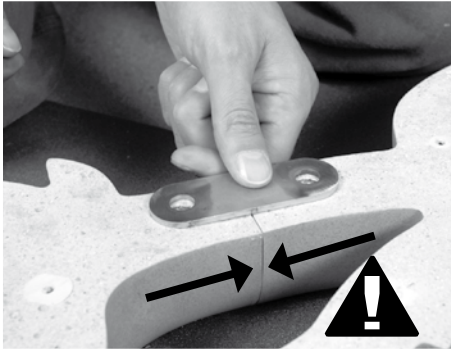



Montážní návod ventilů - Montážní pokyny ventilů

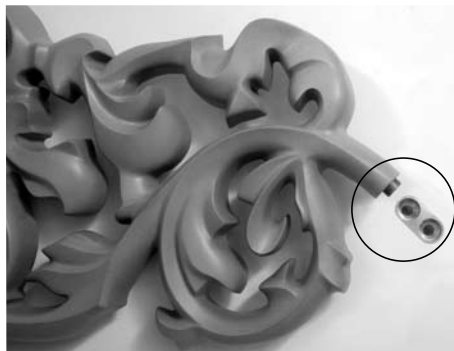

C

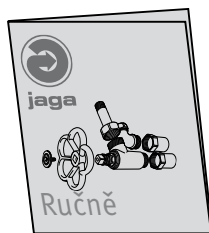

připojení - pripojenie

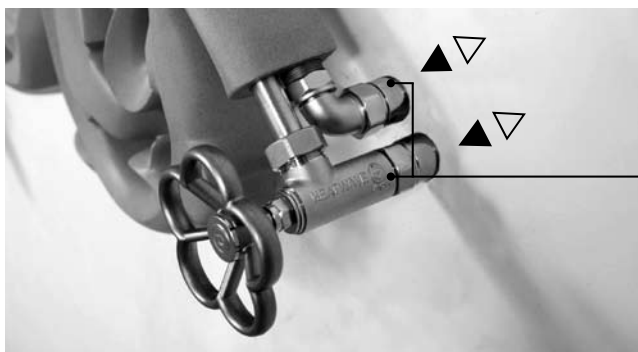

**Varování:** během pracovního postupu se mohou části ventilů zahřát.

**Upozornenie:** počas pracovného postupu sa môžu časti ventilov zahriať.

Jednotlivé díly - Súčiastky

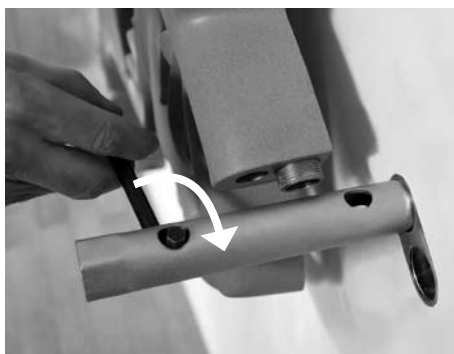
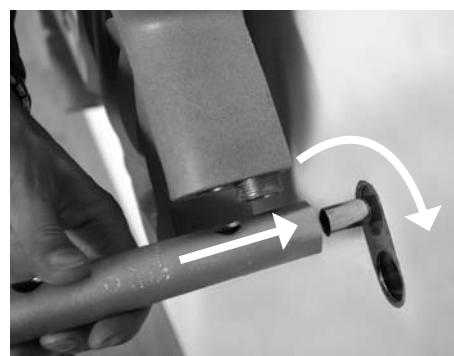
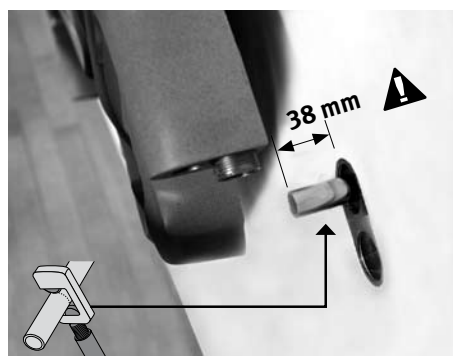
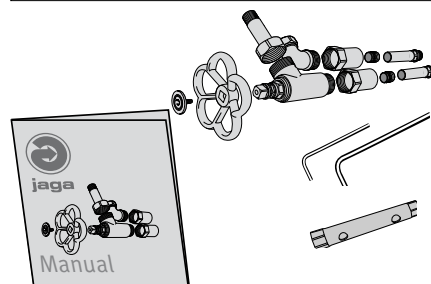

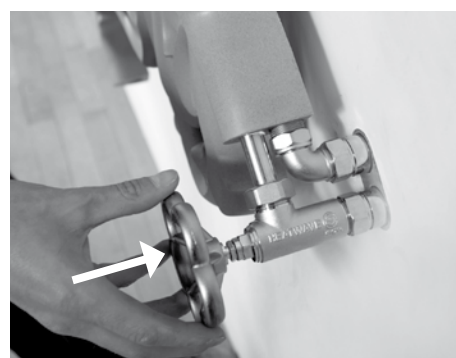
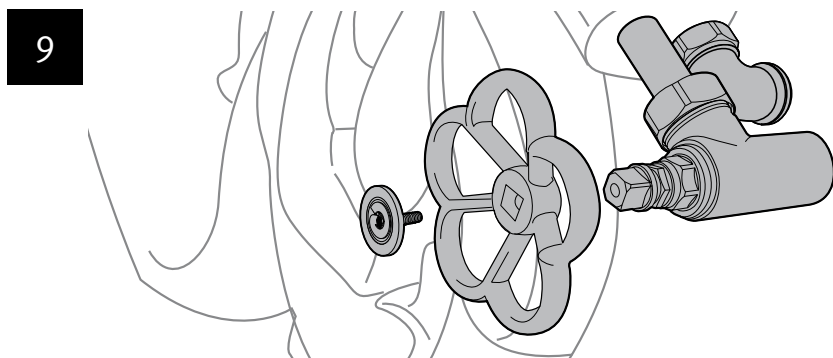
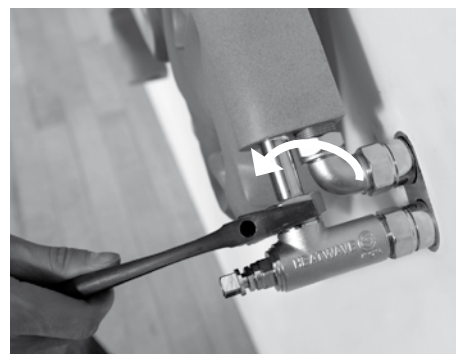
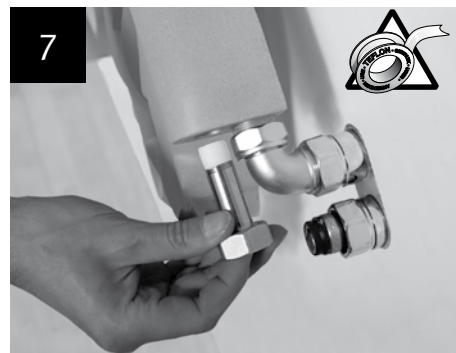
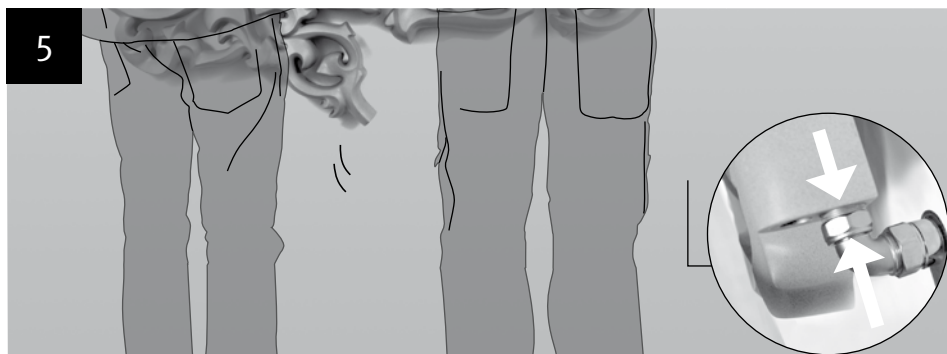



**Odvzdušnění - Odvzdušnenie**

Odvzdušnění tělesa Heatwave je prováděno přes centrální odvzdušňovací ventil. Po dobu čištění tělesa zajistěte, aby všechna ostatní připojení v okruhu byla uzavřena.

Odvzdušnenie telesa Heatwave realizova centrálnim odvzdušňovacím ventilom. Počas doby istenia telesa zaistite, uzavretie všetkých zostávajúcich pripojení v okruhu.

